

# DesignerWood™ Aluminium Image

Fire-rated aluminium batten and plank system  
with a photo-realistic timber finish

## Technical Detail & Installation Guide

## Photo-realistic timber with the confidence of fire compliance

Atkar Group are dedicated in meeting market requirements around fire compliance whilst offering aesthetically compelling solutions to fit the modern design brief. Our DesignerWood™ Aluminium batten and cladding range includes two outstanding options – a genuine timber veneer and a photo-realistic timber finish. DesignerWood™ Aluminium Image is fire-rated and offers the visual charm of timber with its photo-realistic image, but has no maintenance requirements, making it the perfect solution for many project requirements.

DesignerWood™ Aluminium Image offers:

- ✓ Non-combustible compliant & Group 1 Rating
- ✓ Photo-realistic timber image
- ✓ 18 colour options most with unique texture
- ✓ Internal & external applications
- ✓ Quick & easy installation
- ✓ Batten & plank options

This Page: DesignerWood™ Aluminium Image in Acacia

Front: DesignerWood™ Aluminium Image in Brown Oak



## CONTENTS

	Section	Page
<b>Product &amp; Technical Detail</b>	<b>1</b>	<b>4</b>
<b>Maintenance &amp; Cleaning</b>	<b>1</b>	<b>4</b>
<b>Storage, Handling &amp; Cutting</b>	<b>1</b>	<b>5</b>
<b>Installation – Battens</b>	<b>2</b>	<b>6</b>

# TECHNICAL DETAIL

## Application

DesignerWood Aluminium Image is suitable for use as an internal lining on walls and ceilings or as an external decorative cladding for residential and commercial buildings.

## Material

Lightweight solid aluminium hollow profiles with a photo-realistic timber finish.

## Lengths

Battens are available in 5700mm lengths and can be cut to size or fully customised to project requirements.

## Fixing Systems

DesignerWood Aluminium Image battens & planks have a concealed 2 – piece click fixing system. Please refer to page 6 for full fixing and installation details.

## Finish Options

Created to replicate actual timber, our 18 photo-realistic colour options, most of which include a unique texture feel to enhance realism, will complement or add contrast to any surface.

Colour matched end caps are also available to ensure a seamless finish.

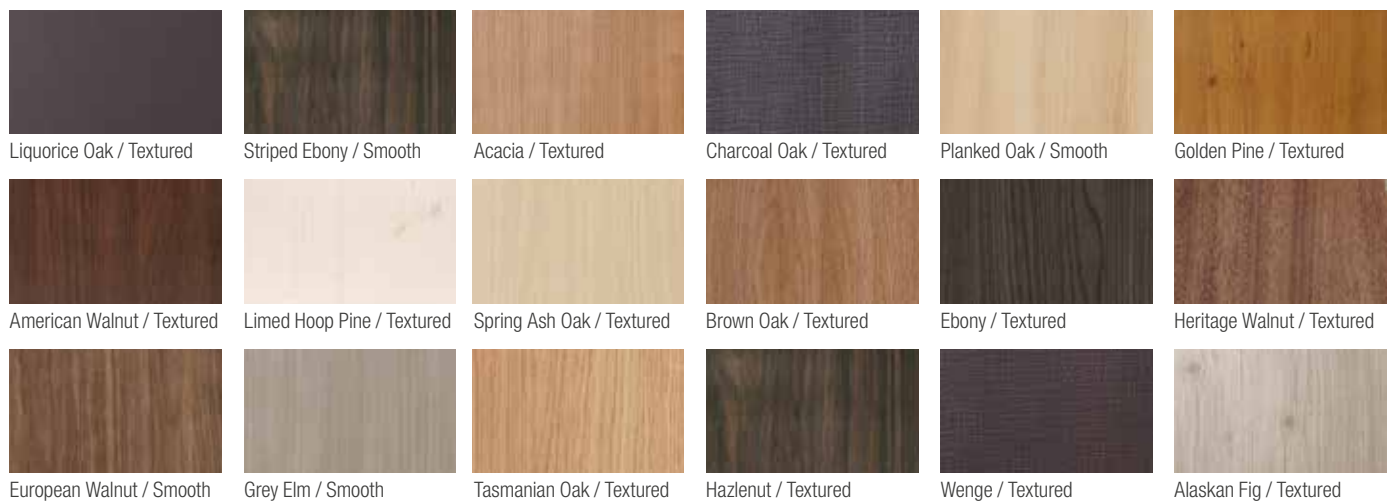

Colours displayed should be used as a guide only. Always confirm your colour choice by requesting a sample.

## Profile Options

Select from one of our standard 2-piece click profile options. Battens are available in 5700mm lengths and can be cut to size or fully customised to project requirements.

Contact our Architectural Team if you have any other profile requirements not listed.



## Maintenance & Cleaning

No maintenance or re-varnishing of DesignerWood Aluminium Image is required.

- For cleaning, a soft and damp cloth can be used.
- High pressure hose is not recommended

## Warranty

10 year warranty against splitting, warping, expanding, fade or insect damage.

Suitable for high UV, high humidity and marine environments.

### Fire Certifications

DesignerWood Aluminium Image has undergone the following fire tests and received the following results. Please contact us to receive a copy of these certifications.

Fire Test	Result	Certificate #
AS5637.1 : 2015	Group 1 Rating	18-003574; 18-003575
AS/NZ 1530.3-1999	Spread of Flame – Index 0 Finish thickness less than 1mm	18-002786; 18-002787

### BCA Compliance

DesignerWood Aluminium Image battens and claddings are suitable where non-combustible materials are required in accordance with Deemed-to-Satisfy Provisions C1.9 (e)(v) of the 2019 NCC, Building Code of Australia.

BCA Section C, Part C1, C1.9 (e)(v) states: The following materials may be used wherever a non-combustible material is required:

- (v) Pre-finished metal sheeting having a combustible surface finish not exceeding 1mm thickness and where the Spread-of-Flame Index of the product is not greater than 0.

## STORAGE, HANDLING & CUTTING



### Unloading from the vehicle

- Necessary and appropriate measures should be used when unloading the materials to avoid unnecessary damage
- It is important that the panel ends do not overhang from the forklift arms more than 2.5m
- For panels that are less than 6m, using a forklift with a narrow arm (1.2m) is recommended
- For panels that are longer than 6m, using a forklift with a narrow arm (3.5m) is recommended



### Taking from the stack

To prevent scratching of the wooden coating adhere to the following:

- Do not pull or slide over the stack
- For lengths that are less than 6m, they should be lifted from both ends
- For lengths that are longer than 6m, they should be lifted from both ends and the middle



### Storing

- Panels should be stacked no more than 1m in height
- Never step on or walk over the stack
- If the materials will be stored for a long time, the stack should not be fully covered in order to avoid condensation
- The panels should always be kept under cover away from rain or humidity



### Use of ropes

- If ties are required, it should be nylon, hemp or silk. Do not use steel or chain ropes
- In order for the ropes not to crush the corners of the panels, wooden chocks should be placed at the bottom and the top of top side of the stack
- Chocks should exceed the panels by at least 3 - 5 cm



### Use of pallets & chocks

- Chock height should be 10 cm and the distance between chocks should be at least 1.5m
- If there is a wooden pallet beneath the pack and there are some panels protruding from the pallet, then they should be supported with wooden chocks to provide support
- The chocks in between the pack should be aligned on top of another panel
- Polyurethane or wooden chocks should only be used



### Cutting

If it is required to cut the profile, it is recommended to:

- Use a fine tooth TCT Aluminium Cutting Blade
- Use of a Mitre Saw is recommended
- Cut in a straight line to ensure neat jointing etc. A pencil can be useful to draw a light line for accurate cutting

# BATTEN INSTALLATION



Figure 1: DesignerWood Aluminium Image - 2 piece click batten profile – 50x100mm

## 2 Piece Click System – Direct Fix

The following installation advice is for our DesignerWood Aluminium Image battens using a direct fix system.

There are various installation systems that can be implemented (eg stand-offs). Please contact your project engineer for recommendations.

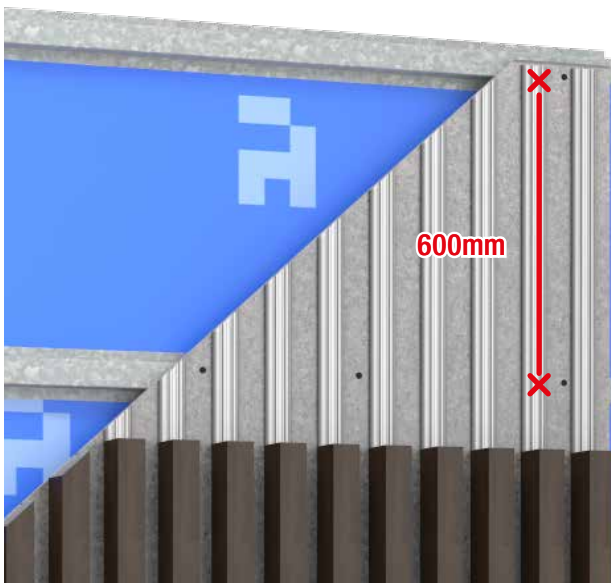

Figure 2: Typical vertical exterior direct fix batten installation – fixing distances

## Fixings & Distances

Battens are to be fixed at a maximum of 600mm centres between screws.

The following fixing screws are recommended:

- External Application: Minimum 10x30 Class 3 Wafer Head Screw
- Internal Applications: Minimum 8 x 30 Zinc Yellow Screw

Coastal areas may require stainless steel fixing screws. Refer to project engineer for advice.



Figure 4: End cap installation

## End Caps

End caps are easily clicked into place after profile has been installed.

Due to expansion and contraction all end caps should be glued into position with Bostik seal n flex 1 or similar.

**Batten Installation Overview**

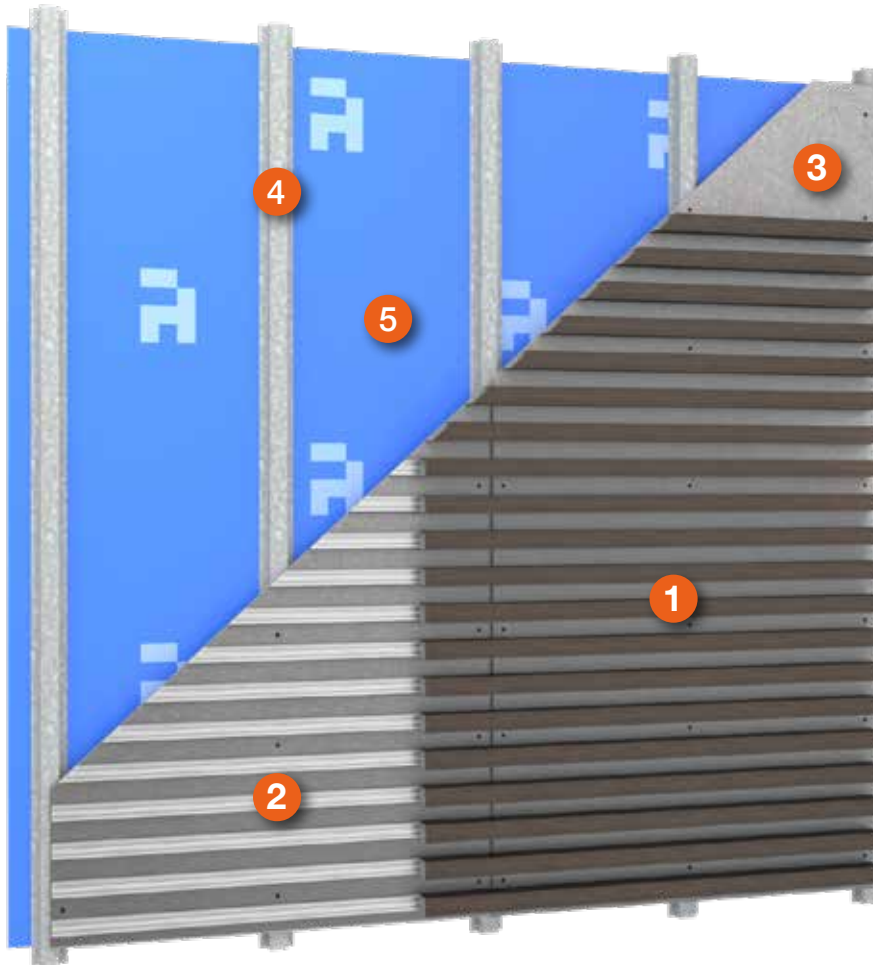

- 1. Battens
- 2. Backing Strip
- 3. Exterior Cladding
- 4. Top Hats
- 5. Weather Barrier

Figure 4: Typical horizontal exterior direct fix batten installation

**HORIZONTAL OR VERTICAL**

DesignerWood Aluminium Image battens can be installed vertically or horizontally.

**BATTEN DISTANCES**

The recommended minimum distance between DesignerWood Aluminium Image battens is 100mm.

**EXTERIOR INSTALLATION**

DesignerWood Aluminium Image battens are not designed to provide weatherproofing of the building, therefore the battens needs to be installed over suitable exterior cladding.

**INTERIOR INSTALLATION**

DesignerWood Aluminium Image battens can be installed directly to most internal linings (eg. Plasterboard) or directly fixed straight to the ceiling grid.

**Tip.** Paint base cladding black for a streamlined look.

**BACKING CLIP**

Once fixing surface is prepared, separate the backing clip from the profile and screw directly to the wall or ceiling.

**BATTEN PROFILE**

Once backing clip is secure, click in the top batten profile. Note: It can be difficult to un-click the profile once it has been clicked into the backing frame. If necessary, carefully use a soft mallet to remove the backing clip.

**JOINING BATTENS**

Butt joints are required when joining battens together. To reduce movement between the joining battens it is advised to use a section of timber or aluminium inside the battens.

It is also important to stagger the Backing Strips across a single batten as this helps to achieve a straight finish.

**Head Office**

17–19 David Lee Road Hallam VIC 3803 Australia

PO Box 1143 Narre Warren MDC 3805

† 03 9796 3333

[atkar.com.au](http://atkar.com.au)



**Disclaimer**

The information in this document is a guide only. It is intended for use by builders, cladding installers and other contractors who may be involved with the installation of the DesignerWood Aluminium.

If you are an installer ensure that you follow the design and preparation requirements and materials as set out by the designer. If you are a specifier or a responsible party for the project, please ensure the information in this manual is appropriate for the application you are planning.

As all project conditions are unique, there are likely to be variations to how this product is used, which can affect the use and quality of the products, as such no warranty is given or implied with respect to such situations.

Atkar Group's policy is one of continuous improvement. We therefore reserve the right to alter specifications at any time and without notice. Colours and textures may vary according to light and weather conditions. Owing to this and limitations of the printing process, colours in this brochure may vary.

Please ensure that you have the latest version of this publication by checking that the publication date corresponds with the downloadable version from our website at [www.atkar.com.au](http://www.atkar.com.au). In case of doubt, please contact Atkar Group.